

## BRUSHLESS DC GEARMOTOR

**A - OUTPUT SHAFT DIAMETER & LENGTH PER CUSTOMER REQUIREMENTS**

**EXTERNAL CONTROL: B = 3.7**  
**INTEGRAL CONTROL: B = 4.7**

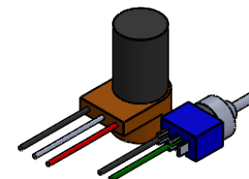
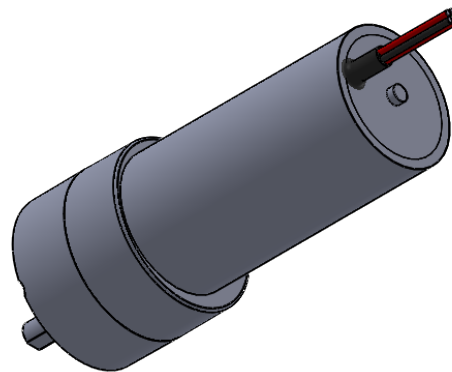

**SPEED & DIRECTIONAL CONTROLS (OPTIONAL)**

- **RATED VOLTAGE 12 VDC OR 24 VDC**
- **OUTPUT RPM FROM 2 TO 1000**
- **OUTPUT TORQUE UP TO 35 IN. LB. DEPENDING ON SPEED**
- **CONTINUOUS DUTY**

UNLESS OTHERWISE SPECIFIED:		NAME	DATE	REX ENGINEERING GEARMOTORS	
DIMENSIONS ARE IN INCHES		DRAWN	RPH	12/6/17	TITLE:  <b>RBLDC</b>
TOLERANCES:		CHECKED			
FRACTIONAL $\pm$		ENG APPR.			
ANGULAR: MACH $\pm$ BEND $\pm$		MFG APPR.			
TWO PLACE DECIMAL $\pm$ .02		Q.A.			SIZE DWG. NO. REV
THREE PLACE DECIMAL $\pm$ .005		COMMENTS:			<b>A</b>
INTERPRET GEOMETRIC TOLERANCING PER:					SCALE: 1:2
MATERIAL					SHEET 1 OF 1
FINISH					
DO NOT SCALE DRAWING					