

**VIEW A:
MOUNTING FOOT DETAIL**

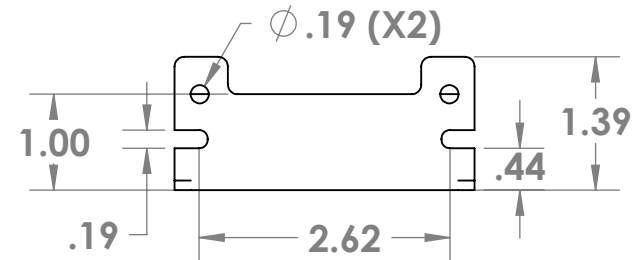

DC REVERSIBLE GEARMOTOR

A - OUTPUT SHAFT DIAMETER & LENGTH PER CUSTOMER REQUIREMENTS

- OUTPUT SPEEDS FROM 0.5-800 RPM
- OUTPUT TORQUE TO 50 IN. LB.
- CONTINUOUS DUTY
- 6-30 VDC

OPTIONS

- HEAVY DUTY NEEDLE BEARINGS
- ELECTRONIC NOISE ATTENUATORS
- 3PPR ENCODER
- BRUSHLESS DC WINDING

UNLESS OTHERWISE SPECIFIED:		NAME	DATE	REX ENGINEERING GEARMOTORS
DIMENSIONS ARE IN INCHES TOLERANCES: FRACTIONAL ± ANGULAR: MACH ± BEND ± TWO PLACE DECIMAL ± .02 THREE PLACE DECIMAL ± .005		DRAWN	RPH 7/17/17	
INTERPRET GEOMETRIC TOLERANCING PER:		CHECKED		TITLE:
MATERIAL		ENG APPR.		SIZE DWG. NO. REV
FINISH		MFG APPR.		
DO NOT SCALE DRAWING		Q.A.		A CDX
		COMMENTS:		SCALE: 1:2 SHEET 1 OF 1